



上海中侨职业技术大学

SHANGHAI ZHONGQIAO VOCATIONAL AND TECHNICAL UNIVERSITY



# 2026 Short-Term Program

**Shanghai Zhongqiao Vocational and Technical University**



Address: No.3888 Caolang Highway, Jinshan District, Shanghai

<https://www.shzq.edu.cn>

# University Profile

## INTERNATIONAL RECOGNITION



# 1st

the only vocational university in China accredited by ACQUIN (German Higher Education Quality Assurance Agency)



# 1st

the only vocational university in China admitted to AACSB (American Elite Business School Alliance)

Shanghai Zhongqiao Vocational and Technical University (hereafter referred to as SHZQU) is a non-profit private university. Founded in 1993, it is one of the first vocational education institutions in China authorized to grant bachelor's degrees.

SHZQU is located in Jinshan, a suburban district of Shanghai. The university comprises 10 secondary schools, offering 24 bachelor's programs and 20 associate degree programs across a variety of disciplines, ranging from engineering to design to culinary arts. As a university fostering integrated collaboration with industry, SHZQU has established extensive connections both at home and abroad.

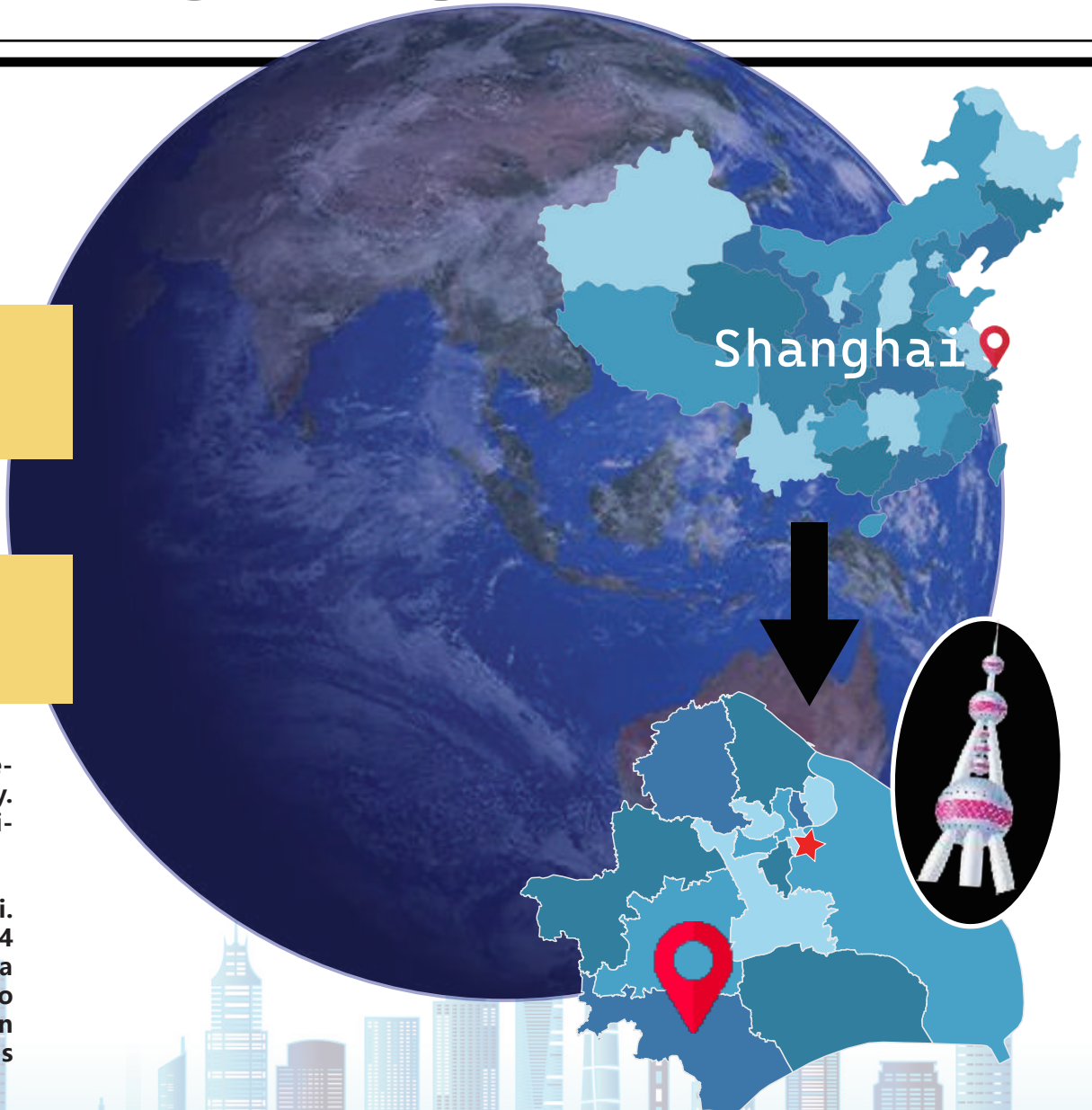

## Jinshan District



## PROGRAM FEATURES

**A window into contemporary China**

**Located in the Shanghai Metropolis**

**Perfect for students who have never been to China**

**Practice and activity-based courses and workshops**

**Customized field study destinations**

**Built-in company visits and excursions to Shanghai scenic sights**

**Duration ranging from one week to three weeks**



This short-term program exposes international students to different aspects of Chinese culture, allowing them to experience both historical and contemporary China. The program's courses have been selected from 10 schools, showcasing the breadth and diversity of what SHZQU has to offer.

At the same time, the courses provide a glimpse into contemporary China, focusing on technological innovation, economic markets, and cultural sustainability. In order to take care of the visitors who come to China for the first time, the program offers an overview of contemporary China.

# Courses

UAV (Unmanned Ariel Vehicle) Application  
Robotics Application  
Streaming and Gaming Industry  
Chinese Digital Economy

New Energy Vehicle  
Chinese Biomedicine  
Big Data and Supply Chain  
Chinese Civil Engineering  
Localization and Sustainability Development



# Workshops

Conversational Chinese  
Traditional Chinese Cuisine  
Chinese Medicine and Acupuncture

Chinese Taichi/ Kungfu  
Jinshan Peasant Painting  
Dragon Boat

Hema Fresh (also known as Freshippo), part of Alibaba Group, is an innovative Chinese supermarket chain combining online and offline retail. It specializes in fresh groceries, seafood, and ready-to-eat meals, offering fast, 30-minute delivery through its integrated app and physical stores.



**Lenovo 联想**



Lenovo Shanghai Future Center, an enterprise-level business innovation center, presents the latest achievements of Lenovo's intelligent transformation in all walks of life.

# Field Study



JIUFENG FARM

Located in Jinshan, Jiufeng Farm is the pioneer in digital agriculture and currently one of the largest automatic farms in Shanghai, covering more than 25 acres.

Jinfeng Liquor



Jinshan has been a historical site of Huangjiu production. Jinfeng Winery's history can be traced back hundreds of years and its produce dominates the traditional rice wine market.

SHZQU's academic programs are closely aligned with industry trends and the evolving needs of the job market. By integrating field studies and company visits into the curriculum, students gain firsthand exposure to real-world business environments, deepening their understanding of theoretical concepts and enabling them to apply their knowledge in practical contexts.

These field studies are highly customizable, allowing students to tailor their learning experiences to their specific interests or academic goals.





**McDonald's**

Zhongqiao Canteen-  
A three-floor building offering a variety of Chinese foods, snacks, McDonald's, and restaurants featuring cuisines from different countries.



**Café**

Zhongqiao Café-  
A cozy space for relaxation and socialization, offering a beverage service area with coffee and tea for students and faculty.



**National Standard Swimming Pool**

Zhongqiao Sports Centre-  
Facilities include a basketball gymnasium, badminton courts, an indoor swimming pool, an equipment room, and more.

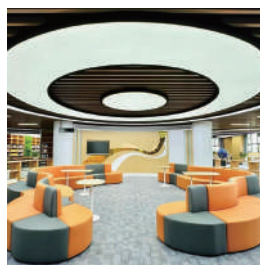

**Library**

Zhongqiao Library-  
Facilities include a reading area, a discussion and study area, a rest area, and a digital interaction area.



# Campus Amenities

# Estimated Expenses

Accommodation: 2000 RMB / 278 USD / 250 EURO.

Food: 60-200 RMB / 8-28 USD / 8-25 EURO per day.

The average cost of a meal in the cafeteria is between 15 RMB / 2 USD / 2 EURO and 20 RMB / 3 USD / 3 EURO , but it depends on students' personal preferences.

Public Transport: 20 RMB / 3 USD / 3 EURO per day. Zhongqiao campus is located in the suburban part of Shanghai. There is a direct public bus to the city center. A taxi ride to the city center costs around 250 RMB / 35 USD / 31 EURO.

Tickets: 1100 RMB / 153 USD / 138 EURO.

Courses and Activity Services: 300 RMB / 42 USD / 38 EURO.



**Welcome to scan the QR code for a video introduction to our Zhongqiao Campus.**